



Student Planning | Course enrolment *redefined*

WebAdvisor & Student Planning Guide

Creating a Plan

Undergraduate, diploma and graduate students can select their courses online using any computer with internet access. Please read this guide and watch the videos to help you get started.



UNIVERSITY OF
GUELPH

UNIVERSITY OF
GUELPH-HUMBER

Overview

Welcome to the Student Planning informational booklet for the University of Guelph, Ridgetown Campus and University of Guelph-Humber. Student Planning is a self-serve system available to all U of G, Ridgetown and Guelph-Humber students who are actively enrolled in a program. It combines optional degree planning with intuitive course search tools and registration in a new, easy to navigate online environment. To assist both new and returning students, a series of training videos and corresponding information sheets have been developed to help guide you through the most common features of Student Planning.

Creating a Plan

Creating a plan of your degree/diploma allows you to take a proactive step in determining the best path for completing your program requirements, all the way to graduation! This can be done by planning current and future semesters based on previous terms.

You create a plan by adding the desired courses to a **“course plan”**. It is important to understand that you have **not** registered in these courses but rather you **plan** to register for the course in the term you have added the planned course to. You are not obligated to register for a planned course nor are you billed for the planned course until you register. You can add, remove or move planned courses into any path that is suitable based on prerequisites, semester offerings and other considerations.

- 3.1 Using your web browser, go to **WebAdvisor** at <https://www.uoguelph.ca/webadvisor> and click the **“Access WebAdvisor”** button.

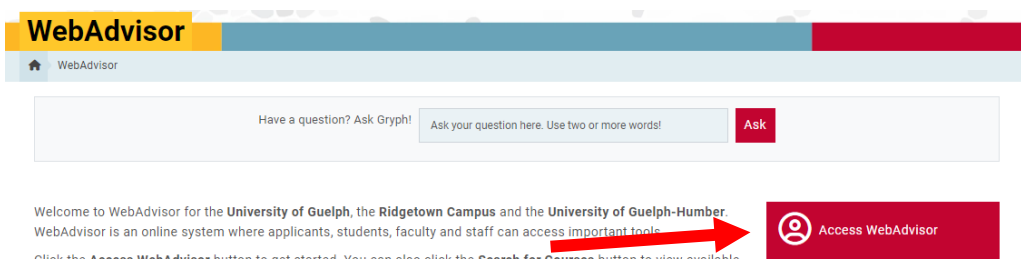

- 3.2 Log in with your Central Login ID and Password. If you are already logged in to Gryph Mail or CourseLink, you will not need to re-enter your login credentials.

- 3.3 Select **“Student Planning”**.

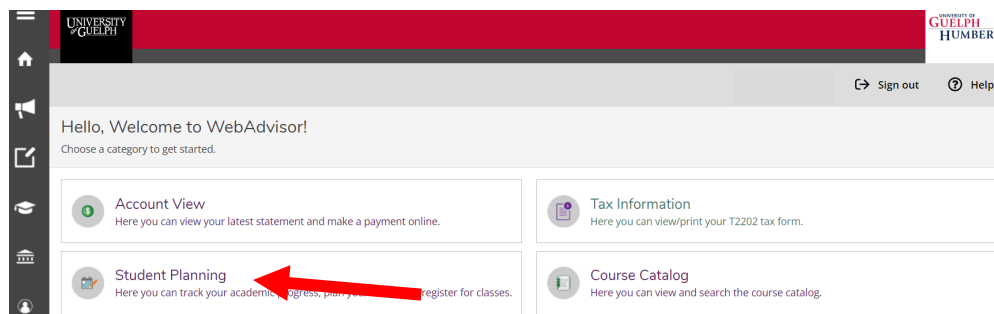

3.4 This brings us to the “**Planning Overview**” page.

UNIVERSITY OF GUELPH

Academics > Student Planning > Planning Overview

Steps to Getting Started

There are many options to help you plan your courses and earn your degree. Here are 2 steps to get you started:

1. **View Your Progress**
Start by going to My Progress to see your academic progress in your degree and search for courses.
[Go to My Progress](#)
2. **Plan your Degree & Register for Classes**
Next, take a look at your plan to see what you've accomplished and register your remaining classes toward your degree.
[Go to Plan & Schedule](#)

Search for courses...

Programs	Cumulative GPA	Progress
BSc Biochemistry	80.089	<div style="width: 80%;"></div>

Winter 2021 Schedule

	Sun	Mon	Tue	Wed	Thu	Fri	Sat
10am							
11am							
12pm			DEV 3400-01		DEV 3400-01		
1pm							

3.5 At a glance, you will find a variety of features which may be helpful for planning your degree. Such features include your *overall cumulative average and your program and major*, if applicable. Additional majors, minors and areas of specialization are not displayed here.

Programs	Cumulative GPA	Progress
BSc Biochemistry	80.089	<div></div>

3.6 This page also shows your current semester’s timetable. Lectures for registered courses are represented in green, and labs and seminars are shown in purple. Planned courses are shown in yellow. Don’t forget to register in your planned courses! Distance Education courses that do not have scheduled lectures, labs or seminars will be listed below the table. For students on the Guelph campus, final exams will also show in this timetable in blue once the schedule has been posted. Because exams are generally spread out over multiple weeks and this schedule shows a single week, you may see overlap in your exams. We recommend going to the “**Plan your Degree & Register for Classes**” page for full exam details.

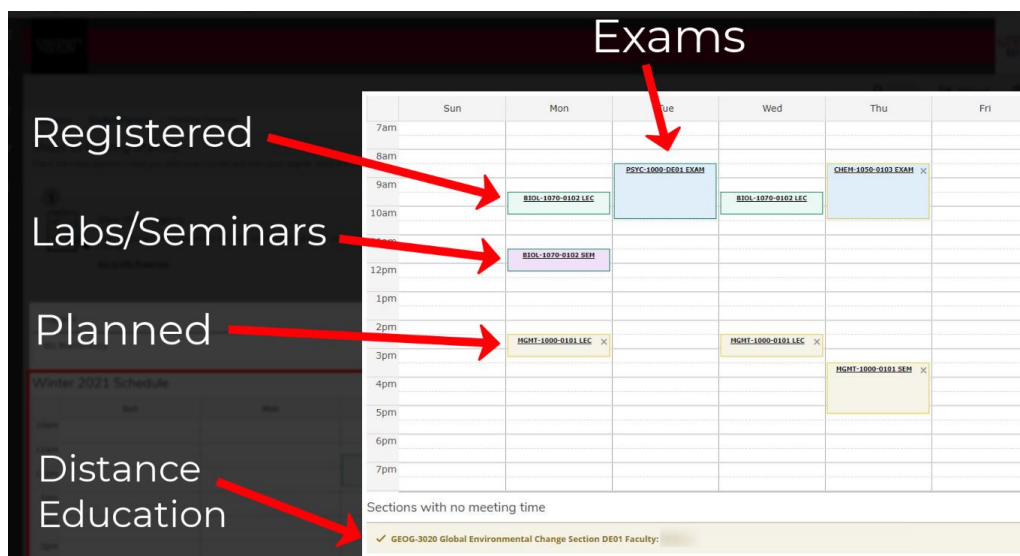

3.7 Aside from the helpful information, this page has two main options - (1) **View Your Progress** where the most powerful planning features are located and (2) **Plan your Degree & Register for Classes**. Click on **Go to My Progress**.

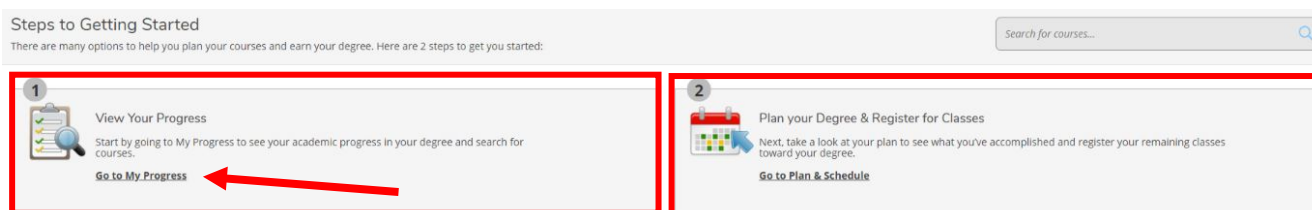

3.8 The **My Progress** page shows all the degree requirements for your program including up-to-date information about what requirements have been completed, what requirements remain and what requirements are currently planned. Scrolling down on this page, you will find more in-depth requirements related to the types of courses that must be completed and the number of credits for each one.

Requirements [Expand All](#)

BSc 1000 Level Limit
Complete the following item. ✓ 1 of 1 Completed. [Show Details](#)

BScH Science Distribution
Complete all of the following items. ⚠ 1 of 2 Completed. [Show Details](#)

BScH 3000/4000 Level Requirement
Complete the following item. ⚠ 0 of 1 Completed. [Show Details](#)

BSc 1.00 Credit Arts/Social Science
Complete the following item. ✓ 1 of 1 Completed. [Show Details](#)

BSc Biochemistry Required Courses
Complete the following item. ⚠ 0 of 1 Completed. [Hide Details](#)

A. Required Courses
Complete all of the following items. ⚠ 0 of 4 Completed. [Hide Details](#)

1.
Take courses BIOC-2580, BIOC-3560, BIOC-3570, BIOL-4540, BIOL-1070, BIOL-1080, BIOL-1090, CHEM-1040, CHEM-1050, CHEM-2480, CHEM-2700, CHEM-2880, CHEM-3750, MATH-1080, MATH-2080, MBIG-2040, MBIG-3350, MCB-2050, MICR-2420, MICR-2430, PHYS-1070, PHYS-1080, STAT-2040. ⚠ 4 of 23 Courses Completed. [Hide Details](#)

Status	Course	Grade	Term	Credits
✓ Completed	MATH-1080 Elements of Calculus I	085	F15	0.5
✓ Completed	CHEM-1040 General Chemistry I	076	F15	0.5
✓ Completed	BIOL-1080 Biological Concepts of Health	078	F15	0.5
✓ Completed	STAT-2040 Statistics I	071	F16	0.5
🕒 Planned	CHEM-1050 General Chemistry II		F21	0.5
🕒 Planned	BIOL-1070 Discovering Biodiversity		F21	0.5
🕒 Not Started	BIOC-2580 Introduction to Biochemistry			

3.9 On the **My Progress** page, there are key course search and planning features available within the Requirements section. To plan for courses in bulk, go to a requirement with courses that have a status of **“Not Started”**. For this section, click on the **“Search”** button towards the top. This performs a custom search, loading only the courses listed under that requirement section.

A. Required Courses

Complete all of the following items. ⚠ 0 of 4 Completed. [Hide Details](#)

1.

Take courses BIOC-2580, BIOC-3560, BIOC-3570, BIOC-4540, BIOL-1070, BIOL-1080, BIOL-1090, CHEM-1040, CHEM-1050, CHEM-2480, CHEM-2700, CHEM-2880, CHEM-3750, MATH-1080, MATH-2080, MBG-2040, MBG-3350, MCB-2050, MICR-2420, MICR-2430, PHYS-1070, PHYS-1080, STAT-2040. ⚠ 4 of 23 Courses Completed. [Hide Details](#)

Status	Course	Search	Grade	Term	Credits
✓ Completed	MATH*1080	Elements of Calculus I	085	F15	0.5
✓ Completed	CHEM*1040	General Chemistry I	076	F15	0.5
✓ Completed	BIOL*1080	Biological Concepts of Health	078	F15	0.5
✓ Completed	STAT*2040	Statistics I	071	F16	0.5
🕒 Planned	CHEM-1050	General Chemistry II		F21	0.5
🕒 Planned	BIOL-1070	Discovering Biodiversity		F21	0.5
⚠ Not Started	BIOC-2580	Introduction to Biochemistry			
⚠ Not Started	BIOC-3560	Structure & Function in Bioche			
⚠ Not Started	BIOC-3570	Analytical Biochemistry			
⚠ Not Started	BIOC-4540	Enzymology			

3.10 To add an *unplanned course*, simply click on the **“Add Course to Plan”** button.

PHYS-1070 Physics for Life Sciences II (0.5 Credits)

This course discusses physics of matter and energy at the macroscopic and microscopic levels, with special emphasis on topics of importance to the biological sciences. Topics include properties of waves, acoustics and hearing, optical systems and vision, quantum nature of radiation and its interaction with biomolecules, electricity, high energy radiation and radioactivity. [Restriction(s): IP5*1510, PHYS*1130, PHYS*1300. This is a Priority Access Course. Enrolment may be restricted to particular programs, specializations or semester levels during certain periods. Please see the departmental website for more information.][Department(s): Department of Physics]

Requisites:
(4U Physics or PHYS*1020), 4U Mathematics - Must be completed prior to taking this course.

Locations:
Guelph

Offered:
Winter Only, All Years

Add Course to Plan

3.11 In the Course Details pop-up, from the dropdown select the **Term** you want to add the planned course to and then click the **“Add Course to Plan”** button.

Course Details

PHYS-1070 Physics for Life Sciences II

This course discusses physics of matter and energy at the macroscopic and microscopic levels, with special emphasis on topics of importance to the biological sciences. Topics include properties of waves, acoustics and hearing, optical systems and vision, quantum nature of radiation and its interaction with biomolecules, electricity, high energy radiation and radioactivity. [Restriction(s): IP5*1510, PHYS*1130, PHYS*1300. This is a Priority Access Course. Enrolment may be restricted to particular programs, specializations or semester levels during certain periods. Please see the departmental website for more information.][Department(s): Department of Physics]

Credits: 0.5

Locations Offered: Guelph

Requisites

- (4U Physics or PHYS*1020), 4U Mathematics - Must be completed prior to taking this course.
- This course is typically offered: Winter Only
- This course is typically offered: All Years

Term: Winter 2022

Add Course to Plan

3.12 Once you are done, you can view all updated changes by clicking on the **“Back to My Progress”** towards the top left of the page.

Search for Courses and Course Sections

[Back to My Progress](#)

Search for courses...

The following results match requirement: Take courses BIOC-2580, BIOC-3560, BIOC-3570, BIOC-4540, BIOL-1070, BIOL-1080, BIOL-1090, CHEM-1040, CHEM-1050, CHEM-2480, CHEM-2700, CHEM-2880, CHEM-3750, MATH-1080, MATH-2080, MBG-2040, MBG-3350, MCB-2050, MICR-2420, MICR-2430, PHYS-1070, PHYS-1080, STAT-2040.

Filters Applied: None

Filter Results

Availability

☐ Open and Waitlisted Sections
☐ Open Sections Only

Subjects

☐ Biochemistry (4)
☐ Biology (3)
☐ Chemistry (6)
☐ Mathematics (1)
☐ Microbiology (2)
[Show All Subjects](#)

Locations

☐ Guelph (22)
☐ Ridgeway Campus (2)

CHEM-1040 General Chemistry I (0.5 Credits)

This course introduces concepts of chemistry, the central link between the physical and biological sciences. Principles discussed include chemical bonding, simple reactions and stoichiometry, chemical equilibria and solution equilibria (acids, bases, and buffers), and introductory organic chemistry. (Department(s): Department of Chemistry)

Information This course was attempted or already completed.

Requisites:
All Chemistry (or equivalent) or CHEM*1060 - Must be completed prior to taking this course.

Locations:
Guelph, Ridgeway Campus

Offered:
Fall and Winter, All Years

[View Available Sections for CHEM-1040](#)

[Add Course to Plan](#)

3.13 To plan for a single course at a time, scroll down to a requirement that has several unplanned courses and click on the course code of a desired unplanned course. By clicking the **course code**, this will perform a custom search with results only for that course.

Planned	BIOL-1070	Discovering Biodiversity
Not Started	BIOC-2580	Introduction to Biochemistry
Not Started	BIOC-3560	Structure & Function in Bioche

3.14 You can add this course to your plan by clicking the **“Add Course to Plan”** button.

BIOC-2580 Introduction to Biochemistry (0.5 Credits)

This course introduces students to the evolution, chemical structure, and biological roles of the major molecular components of the cell: including proteins, nucleic acids, lipids, and carbohydrates. Topics and processes integrated through understanding biological macromolecules include enzymology and intermediary metabolism, with emphasis on catabolic processes. Students will gain basic investigative skills through hands-on experiences in a laboratory setting. (Department(s): Department of Molecular and Cellular Biology)

Requisites:
CHEM*1050 - Must be completed prior to taking this course.

Locations:
Guelph

Offered:
Summer, Fall, and Winter, All Years

[View Available Sections for BIOC-2580](#)

[Add Course to Plan](#)

Once you have planned your required courses, you can search and plan electives and make modifications based on your major, minor, specialization or overall progression. We recommend that you review the Schedule of Studies or program requirements for your program in the Academic Calendar to ensure your plan meets all of the requirements for completing your degree.

3.15 You can navigate to the **Plan and Schedule** page by clicking on Student Planning in the top left-hand corner and selecting Plan & Schedule from the dropdown.

Academics **Student Planning** My Progress

Planning Overview
Plan & Schedule
My Progress

Search for courses...

[View a New Program](#)

At a Glance

BSc Biochemistry
(1 of 1 programs)

Print

3.16 In the **Plan and Schedule** page you can navigate among terms using the arrows on the left-hand side.

Plan your Degree and Schedule your courses

bio 1070

Schedule Timeline

Fall 2021

Remove Planned Courses Register Now

Filter Sections Print

Planned: 1 Credits Enrolled: 0 Credits Waitlisted: 0 Credits

BIOL-1070-0101: Discovering Biodiversity

Planned

Credits: 0.50 Credits
Grading: Graded
Instructor:
9/9/2021 to 12/17/2021
Seats Available: Unlimited

Meeting Information

Register

	Sun	Mon	Tue	Wed	Thu	Fri	Sat
7am							
8am							
9am							
10am							
11am							
12pm							

3.17 To receive a greater view of your degree, click the **Timeline** tab. The timeline displays *completed courses, in-progress courses and courses planned in the future* for each term you add to the view.

Plan your Degree and Schedule your courses

Search for courses...

Schedule Timeline Petitions & Waivers

Add a Term Remove Planned Courses

Winter 2021 Summer 2021 Fall 2021 Winter 2022

IDEV-3400-01: Managing/Evaluating Change
Credits: 0.50 Credits

IDEV-3400: Social Justice & Human Rights
Credits: 0.50 Credits

BIOL-1070-0101: Discovering Biodiversity
Credits: 0.50 Credits

CHEM-1050-0101: General Chemistry II
Credits: 0.50 Credits

BIOL-1070-0101: Discovering Biodiversity
Credits: 0.50 Credits

PHYS-1070: Physics for Life Sciences II
Credits: 0.50 Credits

0.50 Enrolled Credits 0.50 Planned Credits 1 Planned Credits 1 Planned Credits

3.18 Here, you can easily rearrange your planned courses by term using the drag and drop feature. You can move any course you have not completed or have not registered for.

Schedule Timeline Petitions & Waivers

Add a Term Remove Planned Courses

Winter 2021 Summer 2021 Fall 2021 Winter 2022

IDEV-3400-01: Managing/Evaluating Change
Credits: 0.50 Credits

IDEV-2400: Social Justice & Human Rights
Credits: 0.50 Credits

BIOL-1070-0101: Discovering Biodiversity
Credits: 0.50 Credits

CHEM-1050-0101: General Chemistry II
Credits: 0.50 Credits

BIOL-2580: Introduction to Biochemistry
Credits: 0.50 Credits

BIOL-2580: Introduction to Biochemistry
Credits: 0.50 Credits

PHYS-1070: Physics for Life Sciences II
Credits: 0.50 Credits

0.50 Enrolled Credits 0.50 Planned Credits 1 Planned Credits 1 Planned Credits

Schedule Timeline Petitions & Waivers

Add a Term Remove Planned Courses

Winter 2021	Summer 2021	Fall 2021	Winter 2022
IDEV*3400-01: Managing/Evaluating Change Credits: 0.50 Credits	IDEV*2400: Social Justice & Human Rights Credits: 0.50 Credits	BIOG-2580: Introduction to Biochemistry Credits: 0.50 Credits ⚠️ CHEM*1050 - Must be completed prior to taking this course BIOL-1070-0101: Discovering Biodiversity Credits: 0.50 Credits CHEM-1050-0101: General Chemistry II Credits: 0.50 Credits	PHYS-1070: Physics for Life Sciences II Credits: 0.50 Credits
0.50 Enrolled Credits	0.50 Planned Credits	1.50 Planned Credits	0.50 Planned Credits

Please note that most courses are not offered every term. If you drag a course into a term that it is not usually offered in, a message will appear below the course title. If a course is missing a prerequisite, a warning message will also appear below the course title. It is the student's responsibility to ensure that prerequisites are planned accordingly to avoid scheduling complications in future terms.

Fall 2021

BIOL-1070-0101: Discovering Biodiversity
Credits: 0.50 Credits

CHEM-1050-0101: General Chemistry II
Credits: 0.50 Credits

IDEV-2400: Social Justice & Human Rights
Credits: 0.50 Credits

⚠️ IDEV*1000 or ILS*1000 - Must be completed prior to taking this course.

⚠️ Course is not typically offered this term.

1.50 Planned Credits

3.19 To add more terms to your plan, simply press the **“Add a term”** button and select the desired term.

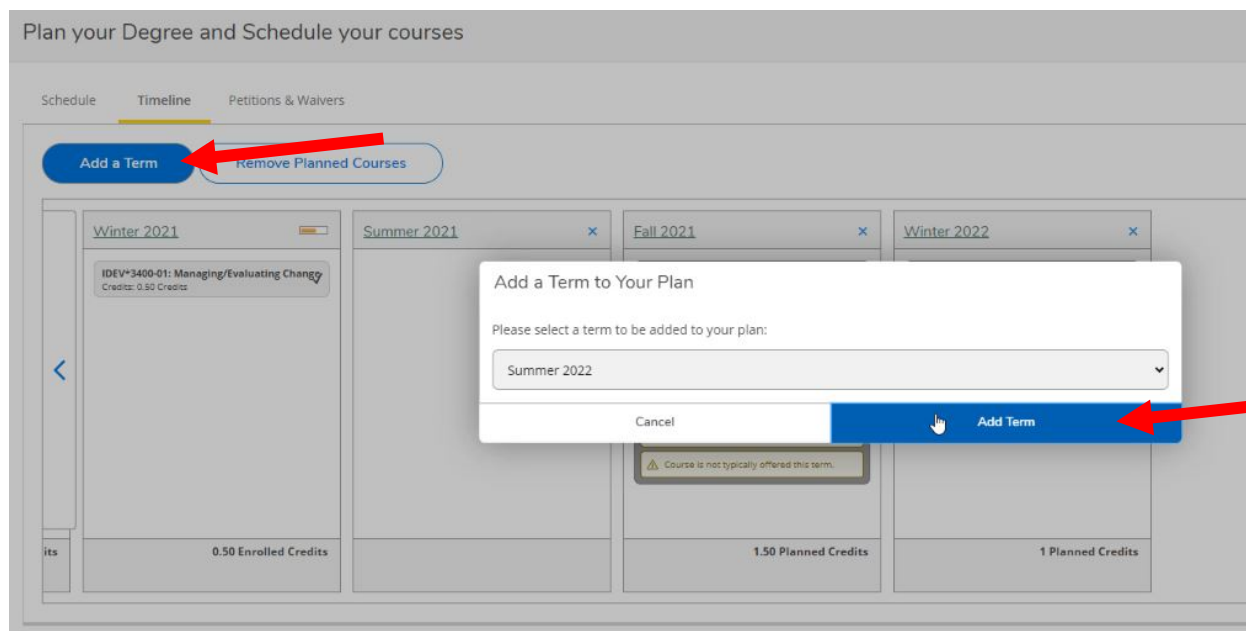

3.20 If you wish to discard a course or an entire term, hit the **X** located next to each one.

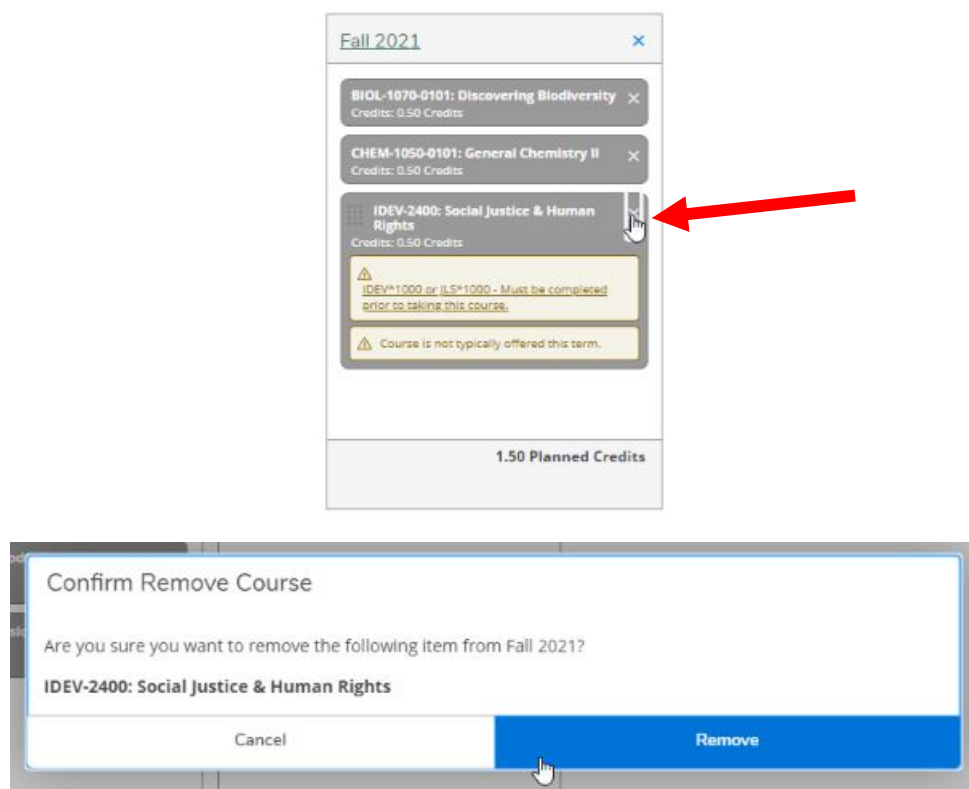

3.21 To discard all planned courses, hit the ***“Remove Planned Courses”*** button.

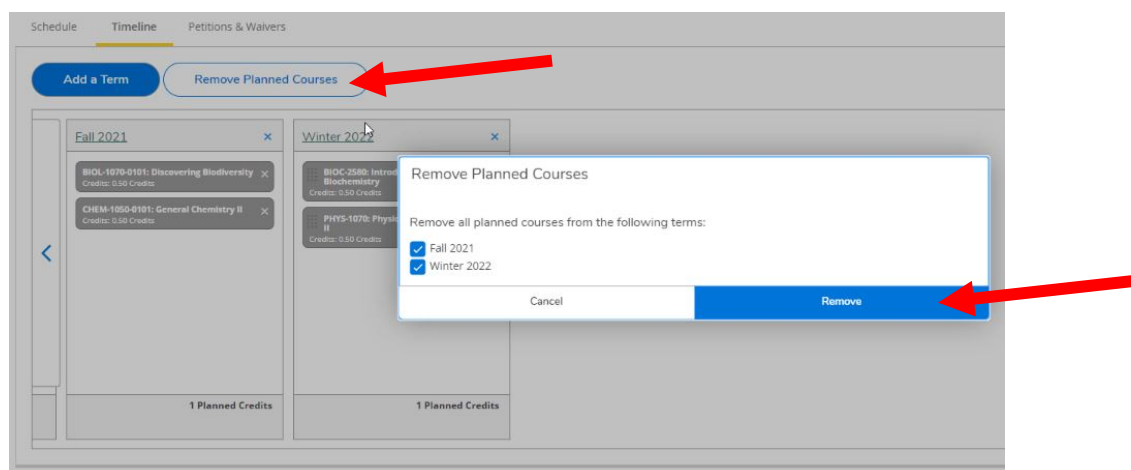

NOTE: It is important to keep your planned courses/semesters up to date. Information may display incorrectly on the "My Progress" page if you leave a course planned in a future semester when you are currently registered in it or have already completed it.

You can register for courses in the “Schedule” tab if you’re within the course enrolment period for one of the terms.

3.22 You can also print your planned schedule using the ***“Print”*** button on the page.

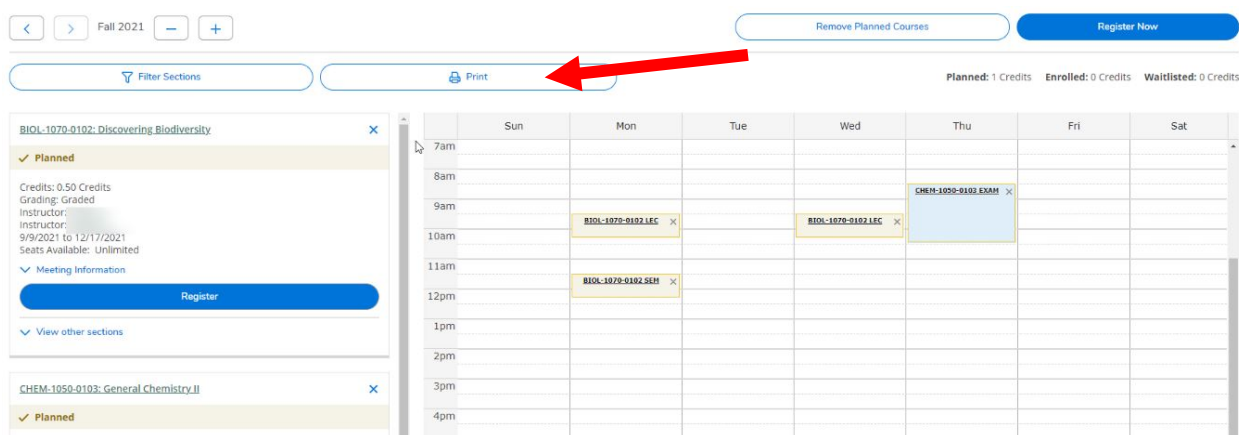

Questions?

Watch our Student Planning videos and read the FAQs on your campus's Student Planning website for more information about degree planning and course enrolment at the University of Guelph, Ridgetown campus and University of Guelph-Humber.

- [Student Planning website for Guelph and Ridgetown students](#)
- [Student Planning website for Guelph-Humber students](#)